

Numazu Newsletter

No. 272

January 15, 2014

Voluntary Supporters
Kalamazoo Division NICE

<http://www.city.numazu.shizuoka.jp/>

You can get information about Numazu twice a month on this home page and some hard copies issued by Supportive Volunteers at the Tourist Information Office at the Numazu Station, Palette, the City Library Participation, the City Gymnasium, Speakeasy, the Tap Room, Catholic Church, Kato Gakuen, Chiku Centers and the City Hall

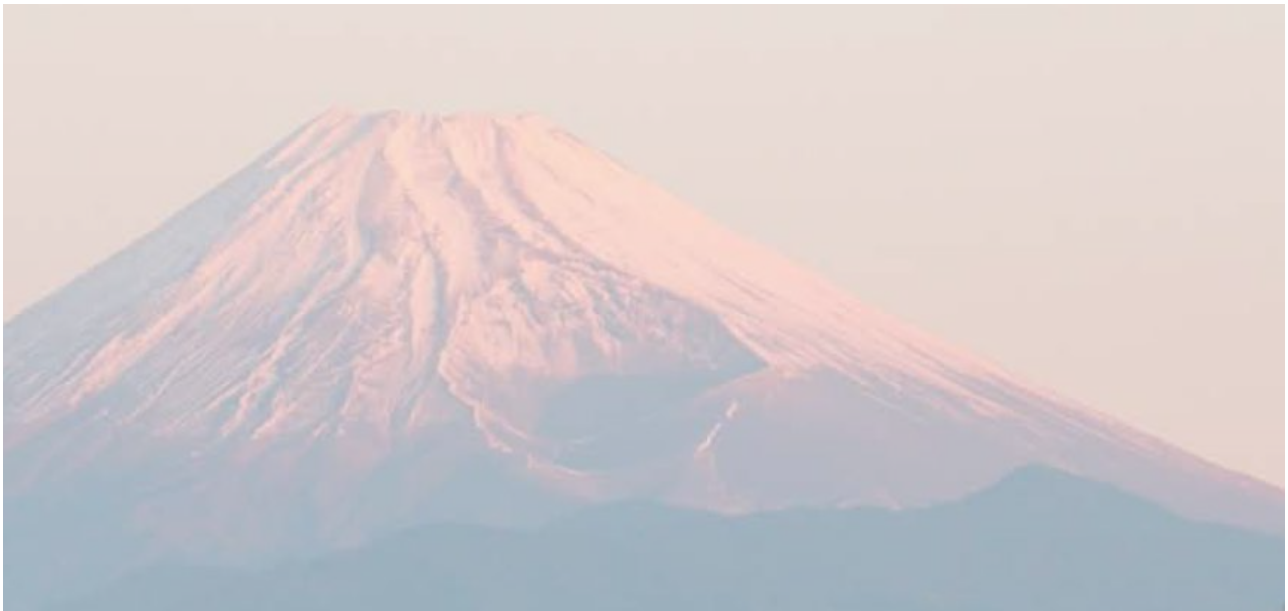

Mt.Fuji seen from Uchiura Nagahama

Events

2014 Numazu Flea Market & Consumer Exhibition



Inquiries: Garbage Control Promotion Division ☎ 055-934-4743
Civic Consultation Center ☎ 055-934-4841

When: Feb. 2(Sun), 10:00 ~ 15:00

Where: Kira Messe Numazu, Multi-purpose hall & Civic salon

Fee: free (Please bring your own bag for shopping.)

Flea Market

There are 168 booths.

You may find an item that you have been looking for.



Consumer Exhibition

◆Stage Event (When: 10:30 ~ 13:30)

Time	Contents
10:30 ~	Little dramas for preventing Consumer fraud
10:50 ~	Consumer's life 'Storytelling with pictures'
11:10 ~	" <i>Fuji-san Kappore</i> " dance
11:30 ~	Is the indicated food volume correct? (Let measure the volume yourself.)
12:00 ~	"Such nice things from garbage" lottery
12:30 ~	Little dramas for preventing Consumer fraud
13:00 ~	Consumer's <i>senryu</i> (humorous haiku) introduction

◆Booth at the site

* Exhibition of panels

Activities of groups involved in our daily life are introduced.
You can also find a hospital for toys, health checkup corner, etc.

* Food selling corner

Dried fish, fresh vegetables, tea, etc. will be sold.

* Usable things found in garbage

There are a lot of things that can still be used. They will be exhibited after being fixed. There will be a drawing for them.



The 4th Numazu Ecological Contest

Inquiries: Environmental Policy Division ☎ 055-934-4741

Under the slogan of aiming for creating ecological city Numazu, the 4th Numazu Ecological Activity Contest will be held. In the contest, a variety of ecological attempts in homes and communities will be presented.

When: Feb. 9(Sun), 13:00 ~ (Open at 12:30)

Where: Cultural Center, small hall

Fee: Free



*Exhibition introducing companies and groups energy and natural resources saving efforts

When: 10:00 ~ 16:00

Where: Exhibition room, and others

◆Contest: 13:00 ~ 15:00

Groups and organizations working for ecological issues will present their activities and results on the stage. An excellent one will be awarded.



◆Ecology Theater

-Picture story show - "Santa Claus out of season (*Kisetsu hazure no Santa Claus*)"

A heartwarming story of children and a Santa Claus set in a forest in Japan

When: 15:00 ~ 16:00

◆Award Ceremony: 16:00 ~

Enjoy Running along Kano River

Inquiries: Commerce and Industry Promotion Division ☎ 055-934-4748

◆ Numazu Sweets Run

You can taste about 20 kinds of mouthful-size pastries and high quality sweets while running along Kano River!

When: Mar. 1(Sat), 10:00 ~ 12:00 (Reception: 8:30 ~ 9:30)

Where: Central Park

(In case of bad weather, it will be cancelled.)

Circuit Course: Central Park ~ Minato-Ohashi Bridge ~

The stepped bank of Kano River
(in front of River Side Hotel)

*about 3.4 kilometers per round / **There are stairs in the course.

Capacity: about 300 people

Fee: 2,000 yen / Application deadline: Feb. 14(Fri)



◆ Kano River View Line Relay Run

When: Mar. 16(Sun), 10:00 ~ 12:00 (Reception: 8:30 ~ 9:30)

(In case of bad weather, it will be cancelled.)

Where: Central Park (*Chuo Koen* Park)

Circuit Course: Central Park ~ Minato-Ohashi Bridge

16 kilometers (about 3.2 kilometers per round x 5 times)

Capacity: about 100 teams (1 team consists of 3 to 5 people.)

Things to bring: *Tasuki* (a sash: It does not need to be a ring.)

Fee: 3,000 yen per team / Application deadline: Feb. 28(Fri)

***For both applications:** Come to the office or by e-mail.

Inquiries and applications: Numazu Running & Skills Station

☎ 055-952-3222 FAX: 055-952-4920

e-mail address: info@n-sta.com / Website: <http://n-sta.com/>

Classes

Hanging Basket Class

Inquiries & Application: Park & Tree Planning Division ☎ 410-8601 Numazu City Hall

☎ 055-934-4796

When: Feb. 13(Thu), 13:30 ~ 15:00

Where: *Senbon* Plaza (Multi-purpose Hall)

For: People living in the city

Capacity: 35 persons (In case of too many applicants, there will be a drawing.)

Fee: 2,000 yen (for materials)

What to bring: thin latex gloves, flower scissors

How to apply: Send an *ofuku-hagaki*, writing your address, name, and telephone number.

Please write 'Hanging Basket Class' on the front of the postcard clearly.

Deadline: Jan. 30(Thu) *A participant must send only one postcard.



Lectures on Cultural Assets: in Dai-go Chiku Center (Meeting Room)

Inquiries: Cultural Assets Center ☎ 055-952-0844

***Lecture Meeting**

When: Feb. 9 (Sun) 13:00 ~ 15:00

Theme: Old *Tokaido* street and Numazu, Traveling to Cultural Assets in Numazu

Lecturer: Curators of the Cultural Center

Capacity: the first 200 persons (Please come on the day.)

***Exhibition of Relics**

When: Feb. 8 (Sat) 13:00 ~ 18:00 / Feb. 9 (Sun) 10:00 ~ 17:00

Recruitment

Temporary Nursery Teachers and Cooks for Public Nursery Schools

Applications and Inquiries: Child Support Division ☎ 055-934-4826

Working Day: basically Monday through Saturday

Contents: 1) infants education 2) cooking in nursery schools

Qualification: 1) people who have an appropriate childcare certificate

2) people who have a cooks license certificate

*They are going to start their work on April 1.

*Please ask us about the details.



A Fureai Bus Tour to See Municipal Administration (A Visit to Public Facilities)

Inquiries: Consultation Center For Citizens ☎ 055-934-4700

When: Feb. 4 (Tue), 9:30 ~ 15:30

Where to meet: City Hall Entrance at 9:20

Where to visit: Kano River purifying plants, Suruga Bay Numazu Service Area on Shintomei highway (lunch time), Clean Center, City Council Conference facilities

*You have to pay for your lunch.

Applicants: people who live in Numazu

Capacity: 23 people (the first 23 people)

How to apply: by phone after Jan. 23 (Thu), 8:30 ~

Events

Numazu UNESCO Festival

Inquiries: Numazu UNESCO Association (inside Culture Promotion Division) ☎ 055-934-4812

When: Jan. 25 (Sat), 12:30 ~ 15:30

Where: Numazu Cultural Center (Big Hall)

Contents: performance of traditional arts or Japanese drums which have been passed on around eastern area of Shizuoka Prefecture

*No reservations. Please come to the place directly.

Soreike Anpanman! (Go! Anpanman) Musical: Yukino Hanani Utao! (Sing to the Flower of Courage!)



©やなせたかし/フレーベル館・TMS・NTV

Inquiries: City Cultural Center ☎ 055-932-6111

Inquiries: Cultural Promotion Division ☎ 055-934-4812

When: Mar. 2 (Sun), ①starts at 11:30 (Doors Open: 11:00)

②starts at 15:00 (Doors Open: 14:30)

Where: Numazu Cultural Center (Big Hall)

Admission: Advance ticket = 2,500 yen *all seats reserved

*A ticket on the day = 2,700 yen

*Children (age 3 and older) have to pay for a ticket. Children under 2 are allowed to see the performance on their parent's knee for free.

Tickets: Tickets are available at Numazu Cultural Center or ticket agencies after Jan. 18 (Sat).

A Party for Marriage Hunting at a Restaurant with an Ocean View

Applications and Inquiries: Matsuda-san, NPO IBA *Mirai Juku* ☎/FAX: 055-967-1309

Inquiries: Civic Collaboration Division ☎ 055-934-4807

This is a buffet-style reception for marriage hunting.

When: Feb. 8 (Sat), 17:00 ~ 20:00

Where: Tony's Honolulu Numazu Bayside (in Numazu Fish Market INO)

Applicants: single men and women (age 25 ~ 50)

Capacity: 40 men and 40 women

*In case of too many applicants, we will have a drawing.

Fee: Men=3,500 yen, Women=3,000 yen (for food etc.)

How to apply: by phone or fax by Jan. 31 (Fri)

Numazu Shogekijo Wahha (Numazu Theater for Comedy):

The 30th Machinaka Yose (Story-teller's Performance)

Inquiries: NPO Machizukuri Center Numazu ☎ 090-8180-7104

Inquiries: Commerce and Industry Promotion Division ☎ 055-934-4748

This is the 30th anniversary event, where you can enjoy Hayashiya Shozo's performance.

When: Feb. 2 (Sun), starts at 14:00 (Doors Open: 13:30)

Where: Shinraku-ji temple 2F Hall (at Suehiro-cho)

Admission: advance ticket= 2,000 yen, a ticket on the day = 2,200 yen

*Preschool children are not allowed in.

Tickets: Tickets are available at Marusan bookstore in Otemachi, Otemachi Kaikan, Numazu Chamber of Commerce Office.

New Year Events at Senbon Plaza

Applications & Inquiries: *Senbon Plaza* ☎ 055-962-3313

Inquiries: Longevity Welfare Division ☎ 055-934-4834

◆ **Setsubun (traditional end of winter), Storytelling and Throwing Beans**

When: Feb. 2(Sun), 10:30 ~ 11:00

Where: Multi-purpose hall



◆ **The Picture-story Show by Mitsuzawa Gucci**

When: Feb. 2(Sun), 11:00 ~ 11:45 / Where: Multi-purpose hall

◆ **Let's Knit a Scarf with Fingers!**

Where: Feb. 2(Sun), 14:00 ~ 16:00

Where: Multi-purpose hall

Fee: 300 yen

Capacity: 50 people (In order of arrival)

How to apply: Jan. 22(Wed) 10:00 ~ by phone



◆ **Frame Arrangement with Preserved Flowers**

When: Feb. 2(Sun), 14:00 ~ 16:00

Where: Big meeting room

Fee: 1,000 yen

Capacity: 40 people (In order of arrival)

How to apply: Jan. 22(Wed) 10:00 ~ by phone



◆ **Exhibition of Hanging Decorations with Our Wishes**

When: Feb. 14(Fri) ~ 20(Thu), 10:00 ~ 16:00

Where: Free space

※We're looking for hanging decorations!

Please contact us if you can lend hanging dolls during the exhibition.

Information

Information from Resident Registration Division

Inquiries: Resident Registration Division ☎ 055-934-4720

Due to the blackout at the City Hall, the automatic machines for issuing residence certificates and seal registration certificates will be out of service at Takashima-cho branch of Numazu Shinkin Bank and City Hall.

When: Feb. 1 (Sat) all day

Jan. 31 (Fri) is the Due Date of the Payment for Municipal & Prefectural Tax, and National Health Insurance

Inquiries: Tax Collection Division ☎ 055-934-4730

National Health Insurance Division ☎ 055-934-4727

Please be sure to pay the fees.

Payment on Sunday is available as follows:

When: Jan. 26(Sun), 9:00 ~ 15:00

Where: Tax Collection Division (City Hall 2F) and National Insurance Division (City Hall 1F)

Night Acceptance and Consultation of Water Bill Payment

Inquiries: Water and Sewage Service Division ☎ 055-934-4853

Where: Feb. 4 (Tue) until 20:00

Where: Water and Sewage Service Division (Water Utility Department Building, 1F)

Tax Reports for Municipal and Prefectural Tax

Inquiries: Municipal Tax Division ☎ 055-934-4735

We receive tax reports for municipal and prefectural taxes for fiscal 2014 at the places shown below. Please come to one of the places if you need to file a report.

When	Where	Opening Time
Jan. 28(Tue)	Ooka Chiku Center Uchiura Citizens Information Office	9:30 ~ 12:00 13:00 ~ 16:00 * Heda Citizens Information Office
Jan. 29(Wed)	Ooka Chiku Center Shizuura Chiku Center	
Jan. 30(Thu)	Kanaoka Chiku Center Ohira Chiku Center	
Jan. 31(Fri)	Kanaoka Chiku Center Nishiura Chiku Center	
Feb. 3(Mon)	Heda Citizens Information Office	* Cultural Center 9:00 ~ 12:00 13:00 ~ 17:00 (Except Saturday, Sunday and closed day)
Feb. 5(Wed)	Katahama Chiku Center	
Feb. 6(Thu), 7(Fri)	Hara Chiku Center	
Feb. 13(Thu)	Ukishima Chiku Center	
Feb. 14(Fri), 18(Tue)	Ashitaka Chiku Center	
Feb. 19(Wed) ~ Mar. 18(Tue)	Cultural Center (Exhibition Room)	

“Kurura Heda”

Inquiries: Policy Planning Division ☎ 055-934-4740

The nickname for Heda Regional Development Center which will open in 2015 has been decided. It is “Kurura Heda” chosen from 92 entries. Thank you for your entries.

Marriage Counseling for Women

Inquiries: Numazu City Council of Social Welfare ☎ 055-922-1500

Social Welfare Division ☎ 055-934-4824

When: Jan. 26(Sun) 10:00 ~ 12:00, 13:00 ~ 15:00

Where: San-Well Numazu Medium meeting room (2F)

Applicants: Unmarried women

What to bring: Copy of residence card (mentioned or referred to entire family and issued within three month prior to the application date), 2 pictures (3.5×4.5 cm and L-type) and seal

※Please come to the site directly.



“New Play Equipment” in ASHITAKA SPORTS PARK

Inquiries: Park and Tree Planning Division ☎ 055-934-4797

“Twenty-meter Roller Slide” and “Tarzan Rope” have been newly and for the first time equipped in ASHITAKA Sports Park. Come and enjoy them with all of your family.

Free Events

Welfare-Related Job Fair; in Eastern Part of Shizuoka (winter)

Inquiries: Shizuoka (Pref.) Social Welfare Human Resource Center ☎ 054-271-2110

When: Feb. 8 (Sat), 12:00 ~ 16:00

Where: Kira Messe Numazu, Multipurpose Hall

Contents: Information on job offers in the field of welfare, consultations for job interview, etc.

Applicants: Those who want to have a welfare-related job

※No need for applications. Please come to the place directly on that day.

Numazu Corporate Body Association New Year Lecture Meeting

Applications & Inquiries: Numazu Corporate Body Association (Public Utility Corporation)

☎ 055-922-4014

Peter Frankl (Mathematician) is to give a lecture and you can also enjoy “street performance.”

When: Feb. 4 (Tue), 16:00 ~ 17:30

Where: Numazu Riverside Hotel (*Agetsuchi-cho*)

Theme: Equation that makes your life fun ~ living in a global age ~

Capacity: Approximately 150 persons

How to apply: By phone

With a Lot of Friends! Let's Enjoy *Oto-asobi* (eurhythmics) All Together!

Applications & Inquiries: *Ongaku-mura* (Music Village), Matsunaga san ☎ 055-972-6685

You can enjoy “*Oto-asobi*” with Eurhythmic Group ‘FRAN’.

When: Feb. 23 (Sun), 14:00 ~ 16:00

Where: San Well Numazu 4F, Multipurpose Hall

Applicants: Preschool-age children who can walk by themselves and their parents

Capacity: About 20 pairs (40 persons)

How to apply: By phone

Seminar on Handmade Food for Pets

Applications & Inquiries: *Sunto* Veterinarians' Association (SAKURA Animal Hospital)

☎ 055-929-8111

When: Feb. 2 (Sun), 13:30 ~ 16:30

Where: *Susono* City Cultural Center (*Susono-shi, Ishiwaki*)

Lecturer: *Susaki Yasuhiko* san (Alternative Pet Nutrition Association,
Chairperson)

Capacity: Approximately 90 persons / How to apply: By phone



KOHO NUMAZU MEDIA GUIDE

~~facebook & You Tube~~

*Numazu Topics : <http://www.facebook.com/numazucity>

*Numazu.tv : <http://www.youtube.com/user/numazucity>



~~COAST-FM 76.7MHz~~

Program	Mon	Tue	Wed	Thu	Fri	Sat	Sun
(*)Numazu <i>Otakara Hakken</i> 'Let's talk with the mayor!'				18:15 ~18:45			
Event information	9:45~, 13:55~, 12:55~		13:55~, 11:15~				
Koho Numazu	8:11~, 9:55~, 18:55~				11:55~		
Emergency Doctor Service	16:53~				10:00~		10:52~

(*)Not on air on the fifth Thursday

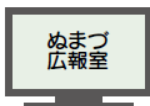

~~Cable TV Program Guide~~

Numazu <i>Koho-shitsu</i>	Mon	Tue	Wed	Thu	Fri	Sat	Sun
Digital (121 ch)	7:45 ~, 11:45 ~, 20:45 ~						
Digital (122 ch)	11:45 ~, 21:45 ~						

◆Daily Life Information Calling for Attention◆

= Coming-of-age means you are legally responsible for everything you do, so be careful when you sign a contract =

Inquiries: Consumers' Life Center ☎ 055-934-4841

Coming-of-Age Day for 2014 has come. Those who have turned twenty are greatly different from those underage in that they are recognized as an adult in society and in that they legally have to be responsible for what they do, which is the same when they sign a contract. In Japan, even though a person who is underage has signed a contract, if it was signed without his/her parents' consent, it is basically possible to invalidate the contract by claiming that it is an "Infant's contract" and is able to be cancelled. However, just after the moment people have reached twenty, they are no longer protected by this system. Signing a contract is an "act of law," which brings responsibility. Please make sure to be very careful when you sign a contract so that you won't get involved in any trouble. If there is any chance of trouble, please contact the Consumers' Life Center to ask for help.

◆Useful Information on Garbage and Trash◆



Inquiries: Garbage Control Promotion Division ☎ 055-934-4743

Empty paper boxes for snacks and gifts can be recycled. Please take out them on "Resource Recovery Day" as "used paper."



Information

New Kadoike Chiku Center Opens

Kadoike Chiku Center is going to open on Feb. 1(Sat), 2014. It is a usable facility and we can use it as a core site in the Kadoike area.

Information

Hours: 9:00 ~ 21:00

Closed: Monday, the following day of a holiday, year-end and New Year days

Application & Inquiries: Kadoike Chiku Center

☎ 055-929-0770 (from Feb. 2 (Sun))

How to apply: Directly to the Center

Before the opening day, apply to Community Association and Promotion Division.



Outline of the facility

Where: Oka-issiki aza Kadoike 788-7 / Floor Space: 1072.85 m²

1階

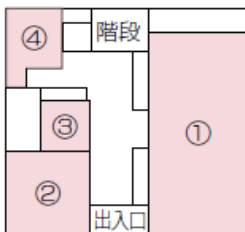

- ①Room for communication and studying and training(*)
- ②Office
- ③Book Corner
- ④WC, Multipurpose toilet

2階

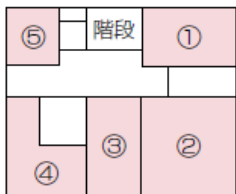

- ①Test Kitchen(**)
- ②Small Meeting Room
- ③Japanese-style Room
- ④Park Management Office
- ⑤WC



(*) The room can be divided into two by a movable wall.



(**) The test kitchen is large and is equipped with five IH ovens.