

Numazu Newsletter

No. 307

July 15, 2015

Voluntary Supporters

Kalamazoo Division NICE

INFORMATION

<http://www.city.numazu.shizuoka.jp/>

You can get information about Numazu twice a month on this home page and some hard copies issued by Supportive Volunteers at the Tourist Information Office at the Numazu Station, Palette, the City Library Participation, the City Gymnasium, Speakeasy, the Tap Room, Catholic Church, Kato Gakuen, Chiku Centers and the City Hall

Information from City Hall

Living in Numazu: the Convenient Guide Book for Foreign Residents

Inquiries: Civic Collaboration Division ☎ 055-934-4717

Guide books titled "Living in Numazu" are being distributed at Civic Collaboration Division (City Hall 2F).

Contents: Information and explanation about procedures necessary for foreign residents to live in Japan. (Resident registration, health insurance, tax, welfare, and others)

Language: There are 4 different versions of English, Portuguese, Spanish and Chinese. (All of them have Japanese in them too.) There is also Japanese language version with kana.

※"Living in Numazu" can be checked on the Internet web site, City Home Page as well.

Enjoy Summer Events in Numazu



City Library's Summer Programs

Inquiries: City Library

☎055-952-1234



***Special Program "My favorite books"**

Exhibition

When: July 21(Tue) ~ Aug.16(Sun)

*Closed on July 27(Mon), Aug.3(Mon), 5(Wed), 10(Mon)

Where: Exhibition Hall (4F)

Story Telling

When: Aug.11(Tue), 12(Wed) 14:00~15:00 / Where: 3rd Lecture Room

*No reservation is needed.

***Waku Waku Library**

puppet show, workshops, recommended books, etc.

When: Aug.6 (Thu) 9:30~14:30 / Where: 4th Floor

*No reservation is needed.



Observation Tour to Garbage Treatment Plants

Applications & inquiries: Garbage Control Promotion Division ☎055-934-4743

When: Aug.5 (Wed) 8:40~12:00

Meeting time and place: 8:30 at City Hall entrance

Tour site: recycling waste integrated site, Tokai Seishi Kogyo Co., LTD.

Applicants: elementary & junior high school students (Guardians must accompany elementary school students under 4th grade.)

Capacity: 22 students (in order of arrival)

What to bring: writing materials, drinks, a hat or a cap

How to apply: by phone, from July 22 (Wed) 8:30



Consumers' Class for Parents & Children

Applications & inquiries: Public Relations Division ☎055-934-4841

When: Aug.7 (Fri) 13:30~15:30 / Where: City Hall (Room 801)

Contents: making *Andon* lamp with a LED bulb

Applicants: 4th ~ 6th graders of elementary school and their guardians in Numazu

Capacity: 20 pairs (in order of arrival)

Fee: 1,000 yen (for material) / What to bring: writing materials

How to apply: by phone or through our homepage, from July 22 (Wed) 9:00



Summer Events at Meiji Historical Museum

Applications & inquiries: Meiji Historical Museum ☎055-923-3335

***Experience of Life during Wartime**

When: Aug.5 (Wed) 10:00~15:00

Contents: lecture of the children's life during the war, cooking *Suiton* soup (dumplings made of flour), visiting the former ammunition storage site

Applicants: 4th ~ 6th graders of elementary school in Numazu

Capacity: 30 students (in order of arrival) / Fee: 24yen (for insurance)

What to bring: drinks, writing materials, gloves, a hat or a cap, towels, a bowl for *Suiton*, chopsticks

*Please wear clothing that you don't mind getting dirty.

***One Day Experience as Curator**

When: Aug.6 (Thu) 10:00~15:00

Contents: Lecture and practical instruction about how to deal with data

Applicants: high school students living in or commuting to Numazu

Capacity: 10 students (in order of arrival)

What to bring: lunch, writing materials *Please wear clothing that you don't mind getting dirty.

***Study Bus Tour to War Historical Sites**

When: ①Aug.9(Sun) 9:00~16:00, ②Aug.12(Wed) 9:00~16:00

Contents: visiting dugout, ammunition storage site, etc.

Applicants: elementary school students and their guardians in Numazu

junior high school students in Numazu (Guardians can accompany.)

Capacity: 23 people each (in order of arrival) / Fee: 24 yen (for insurance)

What to bring: lunch, drinks, a hat or a cap, towels, a flashlight, *Please wear clothing that you don't mind getting dirty.

How to apply for the 3 events above: By phone or come to the museum, from July 22 (Wed) 9:00



San-Well Numazu Event "Let's Make Toys!"

Applications & inquiries: San-Well Numazu *Fureai* Koryushitsu ☎055-922-1501

Social Welfare Division ☎055-934-4824

When: Aug. 22(Sat) 13:30~15:00

Contents: making games with cardboard and clothespins

Applicants: elementary school students / Capacity: 20 students (in order of arrival)

What to bring: drinks, towels, a bag to take the toy home

How to apply: by phone or come to San-Well/City Hall, from July 30 (Thu) 9:30



Parents-Children Fishery Experience

Applications & inquiries: Fisheries and Seashore Division ☎055-934-4753

When: Aug. 21 (Fri) 7:00~12:00 (Cancelled in case of stormy weather)

Meeting place: Car park at *Shige* Beach

Contents: experience of net fishing, tasting a catch in a large pot, lottery, fishery class

Applicants: elementary and junior high school students and their guardians

Capacity: 150 people (in order of arrival) / Fee: 250 yen (for insurance)

What to bring: lunch, drinks, a hat or a cap, towels, *Please wear clothing that you don't mind getting wet.

How to apply: by phone, from July 22 (Wed) 8:30



Numazu Imperial Villa Park — Summer Play School

Inquiries and Applications: Numazu Imperial Villa Park ☎ 055-931-0005

Inquiries: Park & Tree Planning Division TEL: 055-934-4795

****Work experience (using the pinecones of Imperial Villa Park)**

When: 9:00 to 16:30 from July 23(Thu) to Aug. 26(Wed) / Fee: 500yen

*come to the place on the day.

****Play experience (play with the students of Numazu Joho Gijutsu Senmon Gakko)**

When: 10:00 to 15:00 on Aug. 1(Sat) and 2(Sun) *please come to the place on the day.

**Learn with a tree specialist (examine pines in Imperial Villa Park)

When: 9:30 to 11:30 on Aug. 1(Sat), 14(Fri), 15(Sat), 22(Sat) and 23(Sun)

Capacity: 20 people (first come first served basis) / Fee: 1,000yen

How to apply: by phone from 9:00 on July 22(Wed)

◆The following are applicable for the above three.

Where: Numazu Imperial Villa Park

Applicants: infants to elementary school students

*entrance fee is charged. 100yen for adult, 50yen for elementary and junior high school students

*entrance fee for visitors wearing Yukata is free on July 25(Sat), 27(Sun), and Aug. 15(Sat) to 17(Mon).

* parking charge is free for ordinary cars only.



Learning of The Ruins of Nagahama Castle and Tuna Tachikiri Net Fishing

Applications and inquiries: Numazu Tourist Volunteer Guide (within NPO Numazu Tourist Information Center ☎ 055-964-1300)

Inquiries: Tourism and Exchange Division ☎ 055-934-4746

Where: ① 8:00 to 12:00 on Aug. 7(Fri), ② 9:00 to 11:00 on Aug. 10(Mon) (it will be cancelled in case of bad weather)

Place to gather: ① in front of Numazu-ekimae Head office of Watayasu at 8:00 ② The ruins of Nagahama Castle at 9:00

Contents: ① visiting the ruins of Nagahama castle and Historical Folk Material Museum by bus

② observing and walking around the ruins of Nagahama castle

Applicants: fifth and sixth graders living in Numazu and their parents

Capacity: ① 22 people(first come first served basis) ② unlimited

Fee: ① 50yen(insurance) ② free / Things to bring: drinks, hats, towels

How to apply: ① by phone from 9:00 on July 22(Wed) ② come to the place on the day

*please put on loose clothing.



Fish Market Auction Tour

Applications and Inquiries: Numazu Tourist Volunteer Guide (within NPO Numazu Tourist Information Center), ☎ 055-964-1300

Inquiries: Tourism and Exchange Division, ☎ 055-934-4746

When: 5:45 to 7:30 on Aug. 9(Sun)

Place to gather: in front of Numazu Minato Shinsenkan at 5:30

Contents: fish market auction tour by parents and children

Applicants: elementary school students and older and their parents

Things to bring: binoculars (if you have)

*come to the place on the day





Senbon Plaza's Summer Events

Applications and inquiries: Senbon Plaza, ☎ 055-962-3313

Inquiries: Longevity and Welfare Division, ☎ 055-934-4834

Contents		When
①	Wakuwaku! Dokidoki! Science Show (mysterious science experiment and magic)	10:00 to 10:45, 13:00 to 13:45 on Aug. 1(Sat)
②	Work shop(making slime)	11:00 to 12:00 on Aug. 1(Sat)
	Work shop(balloon telephone)	14:00 to 15:00 on Aug.1(Sat)
③	Wakuwaku Kodomo Hiroba(Yoyo fishing and gold fish scooping)	10:00 to 14:00 on Aug. 9(Sun)
④	Making water pistols with bamboo	10:00 to 11:30, 12:30 to 14:00 on Aug. 9(Sun)
⑤	Free style, Football Show	11:00 to 11:20, 13:00 to 13:20 on Aug. 9(Sun)

Where: ①②③⑤—Multi-purpose hall, 4 - craft room

Applicants: ①②③⑤ - anyone , ④- elementary school students

Capacity: ①③⑤ -unlimited ② 100people each (first come first served basis)

④- 30 people each(first come first served basis)

How to apply: ①③⑤- come to the place on the day. ② by phone from 10:00 on July 23(Thu) ④ -by phone from 10:00 on July 30(Thu)



Numazu Kano River Canoe Relay Race

Applications and inquiries: Commerce and Industry Promotion Division ☎ 055-934-4748

When: 9:00 to 14:00 on Sep. 6(Sun)

Where: stairs bank, right bank, Kano River

Applicants: people aged 10 years old and more

Fee: 16,000yen per team (12,000yen for the team consisting of university students and younger)

*a team is four people. / *experience class is held from 10:00 on Aug. 8(Sat)

*Please see the homepage about the details of the application.

Home page address: <http://numazucanoeekiden.i-rai.jp/>



Tour of The Castle Ruins of Sengoku Era for Parents and Children on Summer Vacation

Applications and inquiries: Culture Promotion Division ☎ 055-952-0844

When: 9:00 to 16:00 on Aug. 3(Mon)

Place to meet: in front of the city entrance or the north exit of JR Numazu station

Contents: bus tour of the castle ruins in the city, such as the ruins of Kokoku castle and Nagahama castle

Applicants: third graders to junior high school students and their parents

Capacity: 22 people(first come first served basis) / Fee: 100yen per person(insurance premium)
How to apply: by phone from 8:30 on July 22(Wed)

Child-Raising ~ Child-rearing Support Services



New Service for Birth Registration (Shussho todoke)

Numazu city has started a new service to celebrate and commemorate the birth of babies.

Contents: (1) Present of “Commemorative sheet for Birth Registration” with the image of Birth Registration form and message from the Mayor

(2) Present of Diaper Changing Sheet for Baby and a pack of disposable diapers (82 diapers in it) only for the people who apply for the “Commemorative sheet”

Applicants: People who submit a Birth Registration at Resident Registration Division in the City Hall and wish to have the service

Office Hours: 8:30 ~ 17:00 weekdays

Inquiries: Resident Registration Division, ☎ 055-934-4720



“Ohisama Hiroba”

Childcare workers help you and your children play at the Ohisama Hiroba.

Inquiries: Numazukko Fureai Center (Poppo), ☎ 055-952-8077

When: Aug. 3 (Mon), 11:00 ~ 12:00 / Where: Ito-Yokado Numazu, 2F

Applicants: Children and their guardians

Contents: Hand games, Picture-story show and a lot of fun things

※No reservation required



“Numazu Kosodate Oendan” ~ Website for Child-rearing Support

Inquiries: Health Support Division (Health Center), ☎ 055-951-3480

This website provides vaccination schedule and various information about child rearing. It is free to register for this service. Please make use of this useful service. Access the website from your mobile, smartphone or PC and register for the service.



Applications for the 2016 Fiscal Year for Alternate School Choice under the Nearby School Selection System

Applications and Inquiries: School Education Division, ☎ 055-934-4808

When: Aug. 3 (Mon) ~ 21 (Fri) weekdays only

How to Apply: Fill in the application form which is available at kindergartens, nursery schools, municipal elementary schools, School Education Division (City Hall 7F) and City website, and bring it with your seal to the School Education Division.

※You must meet the condition for the application. Please contact us for the details or visit the city website.

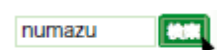



We'll broadcast a Melody “Konoko-no-Kawaisa”

Inquiries: School Education Division, ☎ 055-934-4809

Summer vacation is near at hand. At 18:00 every evening from July 25 (Sat) to Aug. 26 (Wed), the local lullaby in Numazu “Konoko-no-Kawaisa” is broadcasted via wireless broadcast system. When you hear the melody, please tell children playing around in your neighborhood to go home.

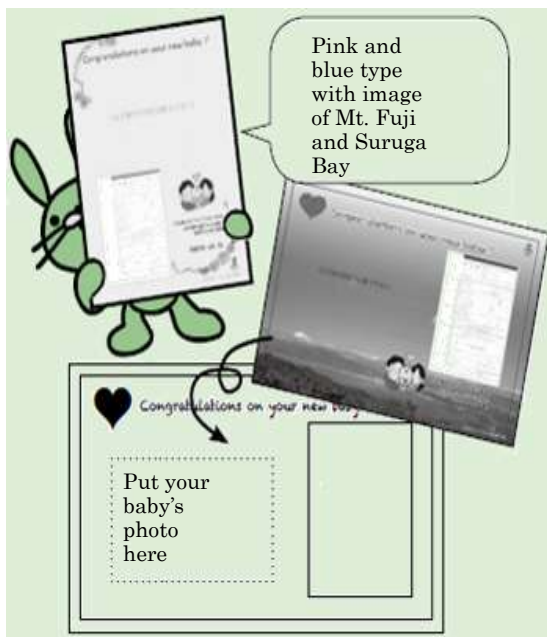

Events

Lecture by *Ebina Kayoko* Talk about the Sorrow after the War and the Joy of Peace' **~70th memorial event of the World War II~**

Applications & Inquiries: Social Welfare Division ☎055-934-4824

Ebina Kayoko's profile: the wife of Rakugo storyteller, Hayashiya Sampei. During the Second World War, she was evacuated to Numazu. She lost her family including her parents and siblings in Tokyo Air Raid in 1945.

When: Aug. 15(Sat), 13:30~14:50 / Where: Numazu Civic Cultural Center, big hall

Capacity: 500 people (first come, first served bases)

How to apply: by phone from July 27(Mon), 8:30

Numazu Techno College Open Campus

Inquiries and applications: Numazu Techno College ☎ 055-925-1071

Inquiries: Commerce and Industry Promotion Division(industry) ☎ 055-934-4799

When: 10:15 ~ 14:00 on July 27(Mon) and Aug. 28(Fri)

Where: Numazu Techno College in Ooka

Contents: presentation of the college, visits to facilities of each department, experiencing classes.

Applicants: people who want to go to the college, and their parents

*Contact us or access the homepage about the details.

Website address: <http://www.numazu-vtc.ac.jp/>

Musical "Rome and Juliet" Review "Flap!"

Inquiries: Cultural Center ☎ 055-932-6111

Cultural Promotion Division ☎ 055-934-4812

When: November 3(holiday), 14:00 open

Where: Cultural Center, main hall

Performers: Hisho Hikaru (OG from Takarazuka Revue), etc.

Fee: 2800 yen (All seats are unreserved), 3000 yen for same-day ticket

*Pre-school child sits on one parent's knee is free. If she/he needs a seat, charge will be required.

Where to get a ticket: At a ticket corner of Cultural Center from August 3 (Mon)



Radio Gymnastic Exercises at Kano River

Inquiries: NPO Numazu City Athletic Association ☎ 055-926-3288

Sports Promotion Division ☎ 055-922-7200

When: Aug. 2(Sun) 7:30 ~ (It will be held even in light rain.)

Where: Chuo Koen Park

※Come to the place directly on the day.

Oku Suruga Bay Seaside Festival

Inquiries: NPO Oku Suruga San San Kai ☎ 055-941-3311

Tourism & Exchange Division ☎ 055-934-4747

When: Aug. 3 (Mon) 14:00 ~ 20:30

Where: Open Space at Uchiura Gyokyo, Mito Swimming Beach

Contents: Firework shows, monkey showman, Japanese drum performance by children, lottery event, *toro nagashi* (Floating lanterns), sea-kayaking, etc.

Free Evens

Tour of Hamaoka Nuclear Power Exhibition Center for Parents and Children

Applications & inquiries: Numazu Construction Industry Association ☎ 055-943-6726

When: Aug. 19(Wed) 8:00 ~ 16:00

Meeting place: NCC *Kyodo-kumiai* Office (Westside of City Hall)

Contents: to visit *Hamaoka* Nuclear Power Exhibition Center and Marine Park *Omaezaki*

*We are going to take a rest at the marine park.

Applicants: children and their parents living in Numazu City

Capacity: 32 pairs (64 people) (on first-come-first-served basis)

What to bring: umbrella, drink

How to apply: By phone, Aug. 3(Mon), 8:30 ~



Weightlifting by Saw-toothed Stag Beetles

Inquiries: Sugisawa-san (Saw-toothed Stag Beetles' Weightlifting Office)

☎ 080-7002-3686

When: Aug. 16(Sun) 13:00 ~

Where: Hara Chiku Center, 2F

Applicants: those who have male saw-toothed stag beetles, which are the native species, with a highly-developed jaw

Capacity: 30 people (on first-come-first-served basis)

How to apply: Come on the day. We'll have selection and explain the competition on the day.

Social Dance Class

Inquiries: Miyashiro-san (Goodies Dance) ☎ 090-3552-9278

When	Time	Where	Applicants
July 23(Thu), Aug. 13(Thu)	13:00 ~ 15:00	Kadoike Chiku Center	for beginners only
July 24(Fri), 31(Fri)		Kanaoka Chiku Center	



Come on the days.

The 30th Anniversary Event of the founding of Numazu Suruga Lions Club

Inquiries: Yagi-san (Numazu Suruga Lions Club) ☎ 055-934-1885

When: Aug. 30(Sun) 13:00 ~ 16:00 / Where: Numazu Cultural Center (Big Hall)

Theme: “A fascinating city, Numazu ~ Why don’t we take another look at our hometown? ~”

Contents: Lecture and dance performance

Performers: Orange Port, Kaze-kagura (yosakoi dance performers)

Capacity: 1,500 people Please come on the day.

Mon Musse Numazu Exhibition in August

“Sugiki Nami’s” “Mitsui Yasunobu’s Robot Exhibition”

When: Aug. 8(Sat) ~ 29(Sat), 10:00 ~ 17:00 (Please enter it by 16:30.)

Aug. 30(Sun), 10:00 ~ 16:00

Classes, Lectures

Muscle Improvement Class

Inquiries: Longevity Care Division, City Hall, ☎055-934-4835, zip: 410-8601

Semester	area	term	when	capacity
3	Shizuura Chiku Center	Tue. & Wed. from	10:00 – 11:30	50 people
	Ohira Chiku Center	Sep.1 – Oct.22	14:00 – 15:30	40 people
	Dai 1・2(Senbon Plaza)	Wed. & Fri. from Sep. 2 – Oct. 14	14:00 – 15:30	40 people
4	Dai 3 Chiku Center	Tue. & Thu. from	10:00 – 11:30	50 people
	Ooka Chiku Center	Nov.5 – Dec.17	14:00 – 15:30	40 people
	Kurura Heda	Wed. & Fri. from Nov.6 – Dec.16	10:20 – 11:50	30 people

Contents: A gymnastics class, exercise to gain muscular strength, and blood pressure measurement

Applicant: Healthy people over 65 years-old who are not certified for nursing insurance.

(Except a person who is prohibited from doing exercise or who receives dialysis)

Fee: 240 yen, including accident insurance

How to apply: On a postcard, write the site name, your address, name, age, your sex, telephone number, and mail it. Or you may use Numazu electronic processing application system. Please go to the Numazu city HP. *There will be a lottery if there are too many applicants.

Deadline: 3rd semester; July 31(Fri), 4th semester; Aug. 31(Mon)

Health Seminar for Elderly People

Applications and inquiries: Numazu Silver Human Resources Center ☎ 055-964-1153

Inquiries: Longevity Care Division ☎ 055-934-4834

When: Aug. 18 (Tue), 13:20 – 15:00 / Where: Koreisya Shugyou Center
 Lecturer: Ms. Takei (NPO International Health welfare Medical Care Academy)
 Applicants: people over 60 years old / Capacity: 20 people
 What to bring: writing utensils / How to apply: From July 22nd (Wed) 9:00, by phone



HANASAKI PC Class

Applications & Inquiries: NPO HANASAKI Net, ☎ 090-6335-8739

Inquiries: Civic Collaboration Division, ☎ 055-934-4807

When: Aug. 18 (Tue) 13:30 ~ 16:30 / Where: San-Well Numazu (2F OA Room)

Contents: Basic skills of PC & surfing the Internet

Capacity: 16 people (In case of a lot of applicants, there will be a drawing.)

How to apply: By July 31 (Fri), by sending ofuku hagaki (double sided postcard) with your name, address, phone number. Send it to 〒410-0857 1-9, Shiba honcho, Mishima City

Labor Law Seminar by Eastern Shizuoka Prefecture Government

Applications and inquiries : Eastern Shizuoka Prefecture Living Center

〒410-0801 Numazu Shoren Kaikan 2F 1-1-3 Otemachi Numazu City

☎ 055-951-8209 FAX: 055-951-8208

Inquiries: Commerce and Industry Promotion Division ☎ 055-934-4749

When: Sep. 11 (Fri), 18 (Fri), 25 (Fri), Oct 2 (Fri), 10:00 ~ 16:30

Where: Numazu Rosei Kaikan (Takashima honcho)

Contents: Labor Standard Act; basic rule for working / Capacity: 70 people

How to apply: by Aug. 17 (Mon), send a postcard with your name address, the name of organization you belong to.

Enjoy Exercises and Sports!

Training, Sports or Physical Fitness Classes in Summer

Inquiries: Sports Promotion Division (in the City Gymnasium) ☎ 055-922-7200

Where: City Gymnasium / Applicants: People living in or commuting to Numazu City

What to bring: clothes for exercise, towels and drinks

How to apply: come to us directly or phone us, after July 22 (Wed), 9:00 –

*Please ask us about the details or check out on the city website.



	Class	Date	Time	Capacity (people)	Fee	Applicant
①	Parent & Child Gymnastics	7 /29 (Wed)	9:30~ 10:20	25 (pairs)		Child who was born between Apr. 2, 2013 and Apr. 1, 2014, and

	(2-year-old Course)				300 yen	his or her guardian
②	Parent & Child Gymnastics (3-year-old Course)	8 / 5 (Wed)	9:30~10:20	25 (pairs)		Child who was born between Apr. 2, 2012 and Apr. 1, 2013, and his or her guardian
③	Oyako Yoga (Yoga for Parent and Child)	7/30 (Thu)& 8 / 6 (Thu)	11:00~11:50	25 (pairs)	600 yen	Child who was born after Apr. 2, 2011 or elementary school students , and their guardian
④	Kodomo Taiiku (P.E.) Class	8 / 4 (Tue)& 8 / 6 (Thu)	10:45~11:45	30	500 yen	Elementary school students
⑤	Pilates	8 / 3 (Mon), 8/17 (Mon), 8/24 (Mon)	9:15~10:15	20	900 yen	Women (junior high school students or older)
⑥	Disco Aerobics	8 / 3 (Mon), 8/17 (Mon), 8/24 (Mon)	10:30~11:30	20	900 yen	Women (junior high school students or older)
⑦	Elastic Band Exercise	7/ 29 (Wed), 8/ 5 (Wed), 8 / 19 (Wed)	10:00~11:00	20	900 yen	Women (40 years old or older)
⑧	Yoga for Women 	7/ 29 (Wed), 8/ 5 (Wed), 8 / 19 (Wed)	13:30~14:30	40	900 yen	Women (junior high school students or older)
⑨	Yoga for Men	7/ 29 (Wed), 8/ 5 (Wed), 8 / 19 (Wed)	14:50~15:50	40	900 yen	Men (junior high school students or older)
⑩	Taikan (Body Core) Training	7/ 28 (Tue), 8/ 4 (Tue), 8 / 18 (Tue)	9:15~10:15	40	900 yen	People (junior high school students or older)
⑪	Lymphatic Massage by yourself	7/30(Thu)& 8 / 6 (Thu)	10:15~11:30	25	600 yen	People (junior high school students or older)

Information from City Hall

“The Exemption System” for National Pension Premium

Applications & Inquiries: Resident Registration Division ☎ 055-934-4724

Those who have difficulty in paying pension premium because their previous-year income was less than a certain amount of money can utilize “the exemption system.” It is strongly recommended for the above-mentioned people to apply for the system, because the pension premium should not be left unpaid. When their applications are approved and accepted, the whole or a part of the pension premium should be exempted. Also only those who are under 30 years old can utilize “the Moratorium System on Premium Payment for Youth.” When their applications are approved and accepted, the period of premium payment should be postponed.

※2 years and 1 month before the time of application should be the period covered by the pension-premium exemption system.

※Please make inquiries about the details.

Consultation on Water Rate Payment on Weekend

Inquiries: Water and Sewage Service Division ☎055-934-4853

When (weekend service): Aug. 8 (Sat), 9:00~12:00

Where: Water and Sewage Service Division (Water service Department Build. 1F)

New Certificate of the Elderly Beneficiary of National Health Insurance is to be delivered

Inquiries: National Health Insurance Division ☎ 055-934-4725

A new certificate of the elderly beneficiary of national health insurance (light purple) is to be sent to each person concerned in late July. When they go to see a doctor after August 1, they should show the certificate with their insurance card at the reception of the medical institute.

Maximum-limited Copayment in the Nursing-Care Insurance

Applications & Inquiries: Nursing Care Insurance Division ☎ 055-934-4874

Government provides a system to reduce the cost of meals and dwelling expenses which should be paid on the occasion of admission to a nursing home or utilization of ‘short stay’ in a care facility. To utilize the system, application procedures have to be done.

Applicants: Person who is a member of a family unit which is excluded from city tax (even if his/her spouse is in another family unit, the spouse needs to be excluded from city tax) and the total of whose deposits and savings is less than a certain amount of money.

Where to apply: Nursing Care Division (Annex to City Hall)

※Please make inquiries for the details.

Automatic Delivering Machines are Not Available

Inquiries: Resident Registration Division ☎ 055-934-4720

Automatic delivering machines for certificates of residence and seal registration certificates which are installed at City Hall and at *Takashimacho* Branch of Numazu Credit Bank respectively need revamping, so they are to be unavailable for all day on the following days.

Date: July 19 (Sun) and 20 (National Holiday)

The 17th Yamaguchi Gen Grand Prize

Inquiries: Cultural Promotion Division ☎ 055-934-4812

Yamaguchi Gen was a woodblock-print-making artist that is connected with Numazu city. The winner of Yamaguchi Gen Grand Prize, which is established to venerate the memory of Yamaguchi Gen, has been selected.

♣The prize winner and his prize-winning work

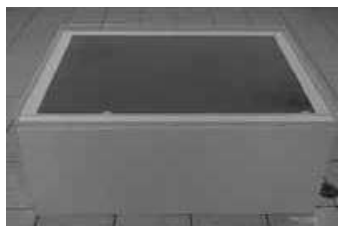

Amano Junji san, residing in Kanagawa Prefecture

“Field of water #013055” silk screen, stencil, paper 93×123cm

♣Acceptance comments

I am really honored to have been selected as the winner of the prestigious prize. I think it has given me confidence in what I have been working on so far and courage to create more works in the coming years.

♣Introduction of the work

I have been producing my works to express materiality in the colors printed on the paper. This work is one of the Water Series as you see in the title.

※”The exhibition of Yamaguchi Gen” is to be held at Mon Muse Numazu in January, 2016.

Numazu City General Education Conference

Inquiries: Education Planning Division ☎ 055-934-4821

Mayor and the members of the educational board are going to exchange their opinions about education of our city and formulate the outline of the education plan and others with consultation and adjustment.

When: July 28 (Tue), 14:00 ~ 16:00 / Where: Committee Room No.2 and No.3 (City Hall 3F)

※This conference is open to the public. If you want to listen, please come to the place directly on the day.

JAPAN HEPATITIS DAY; July 28 (Tue) ~Once-in-a-lifetime hepatitis screening ~

Applications & Inquiries: Health Promotion Division ☎ 055-951-3480

Viral Hepatitis is the disease which is caused by hepatitis virus. When you get infected with hepatitis virus, your liver cells will be broken and the function will be lost. Municipal government is carrying out hepatitis screening until Oct.31 (Sat).

Applicants: People aged over 40 who have never had hepatitis screening

How to apply: By phone

※Ken Tobu Health Care Center is carrying out the hepatitis screening as well. (Prior booking

essential) ☎ 055-920-2109

Let's Try "Knacks of Eco" during Summer Vacation ~Get Energy-Saving Items~

Applications & Inquiries: Environmental Policy Division ☎ 055-934-4741

"Numazu Eco *Kotsu* Action," which may help us to try the knacks for leading an ecological life, has started. Let's try "7-day ecological life in summer," using and filling out a specialized check sheet. Applicants have a chance to get energy-saving goods by drawing lots.

Period covered: 7 days during the period from July 15 (Wed) to Sep.4 (Fri)

How to apply: Send the completed check sheet by mail or by email. You can get a check sheet at the Environmental Policy Division (City Hall 7F) or on the Internet web site, City Home Page.

Application period: No later than Sep.8 (Tue)

Recruitment

Works about Tax

Tax Collection Division ☎055-934-4730

Works: Calligraphy (the title is tax education), posters, compositions

Applicants: 6th graders of elementary school - calligraphy and posters

Junior high school students – compositions

How to apply: bring in via your school by Aug. 31(Mon)



A Poster Inspiring Voting

Applications & Inquiries: Election committee administration office

☎055-934-4815

Works: posters which call out for a bright election

Applicants: elementary, junior high and high school students in Numazu

Poster rules: the subject is free. Drawing paper based upon quarto or octavo size.



How to apply: bring directly or via your school by Sep. 11(Fri). Please write your prefecture name, school name, your grade, name (with kana syllables) and sex down to the right of your works' back.

"Senbon Award" Nominee for the Young

To promote sound growth of children and enhance social awareness, Numazu Lions Club will give the award to young people who encourage other young people by doing activities in sports, cultures and social service actions.

Applications & Inquiries: *Numazu Senbon* Lions Club ☎055-963-0250

Inquiries: Lifelong Learning Division ☎055-934-4871

Deadline: Sep. 10(Thu) *The award ceremony will be held on Oct. 11(Sun). / *Please ask us about the details.



Azul Claro Numazu

Inquires: Azul Claro Suruga ☎ 055-929-8811

Website: <http://www.azul-claro.jp/>

Home Game Azul Claro VS Verspah Oita

When: July 19 (Sun) 14:30 ~ / Where: Multi-purpose Sports Stadium, Ashitaka Park

The results of first stage

Azul Claro Numazu's record was 8 wins, 3 losses and 4 ties and they ranked the 6th place out of 16 teams.

Second Stage Has Started!

Azul Claro Numazu hosted a home game, "Numazu Himono Match" as a second stage opening game on June 28 (Sun). Complimentary tickets were distributed and some events were held and 1,845 spectators came to watch the game. That match ended in a tie.

They will try to win all the game of this stage or be positioned 4th place in the annual ranking to promote to J3 in this stage.

Let's Go Out in The City!

At Chuo Park [Numazu Taiiku Kyokai (Numazu Sports Association, ☎055-926-3288)

Kanogawa Radio Gymnastics

Aug. 2 (Sun), 7:30 –

Radio Gymnastics for people of all ages

At Chuo Park [N-station ☎055-952-3222]

Relaxing Yoga

Every Monday, 11:00 –

Let's do relaxing yoga under the blue sky.



At Numazu Rakuun [Shizuoka Shinbun, Shizuoka Broadcasting System, Tobu branch
☎055-962-6520]

TEAM LAB Island ---Let's Learn and Play in the future Amusement Park!

Aug.1 (Sat) – Aug. 31(Mon), 10:00 –

A smash-hit "Art Exhibition" with "Future Park," produced by a technological art group TEAM LAB, is coming to the Eastern Shizuoka for the first time.

At Ekimae Nigiwai Hiroba [Ekimae Nigiwai Hiroba ☎055-955-7111]

Daidogei Festa (Street Performance in front of Numazu Station)

Every Saturday and Sunday, 11:00~14:30

A couple of street performers will show their performance in turn every week.

At Numashin Street Gallery [Numazu Shinkin Bank ☎055-962-5200]

The Exhibition of Indian Dyed Textiles – Saris and Indian Hand-made Works

Aug. 2 (Sun) – Aug. 28 (Fri)

Exhibition of saris belonging to Ms. Sukrishna Ishii, who live in Numazu



At Numashin Honten Hall [Numazu Shinkin Bank ☎055-962-5200]

Indian Cultural Experience

Aug. 9 (Sun)

The event includes Tagore dance performance, an ethnic fashion show and Sari trial.